

NOTES :

CONSTRUCTION STANDARDS

TO BE CONSTRUCTED IN ACCORDANCE WITH MANITOBA HYDRO DISTRIBUTION AND SUBTRANSMISSION STANDARDS, LATEST EDITION. NO MAJOR CHANGE SHALL BE MADE WITHOUT APPROVAL OF THE DESIGN ENGINEER OR DELEGATE.

SURVEYS TO STAKE OUT SURVEY MONUMENTS, IF IN THE VICINITY OF THE NEW CONSTRUCTION TO PREVENT DAMAGE OR LOSS.

INSTALLED			
Quantity	Fixture Type	Wattage	Pole Type
1	LED	60	EXCLUSIVE
25	LED	90	EXCLUSIVE
6	LED	150	EXCLUSIVE
1	LED	240	EXCLUSIVE

SALVAGED			
Quantity	Fixture Type	Wattage	Pole Type
1	LED	73	EXCLUSIVE
34	LED	138	EXCLUSIVE
1	LED	209	EXCLUSIVE

LOCATION	LUMINAIRE	TYPE	HEIGHT	AVG. LUX	MAX. LUX	AVG. SPACING	MAX. SPACING

PRELIMINARY
NOT TO BE USED FOR CONSTRUCTION

REEL NUMBER	MANUFACTURER	MANUFACTURE DATE

AUTHORITY	NOTIFIED	NOT REQ'D	OBTAINED
DEPT. OF HIGHWAYS		X	
MUNICIPAL		X	
MTS		X	
GIS		X	
EASEMENTS		X	
CONTROL CENTER		X	
RAILWAY		X	
CATV		X	

CONTACT	NAME	PHONE NUMBER	E-MAIL ADDRESS
DESIGN	IAN MCCALLUM	204-470-3154	imccallum@hydro.mb.ca
DESIGN ENGINEER	MATT THEW SINGER	204-360-2001	msinger@hydro.mb.ca
PROJECT MGMT	DARIN WACH	204-360-3902	dwach@hydro.mb.ca
ESA	TIM LOEB	204-360-5157	tloeb@hydro.mb.ca
UIG CONSTRUCTION	BRENT KROEKER	204-793-1570	bkrueker@hydro.mb.ca
GH CONSTRUCTION	WAYNE IRELAND	204-360-5796	wireland@hydro.mb.ca
HYDRO GAS			
SHAW			
MTS			
ENG TECH	PHIL BRUCE	431-373-0496	pbruce@hydro.mb.ca
ENG TECH	GEORGE WEDDALL	204-360-7451	gweddall@hydro.mb.ca

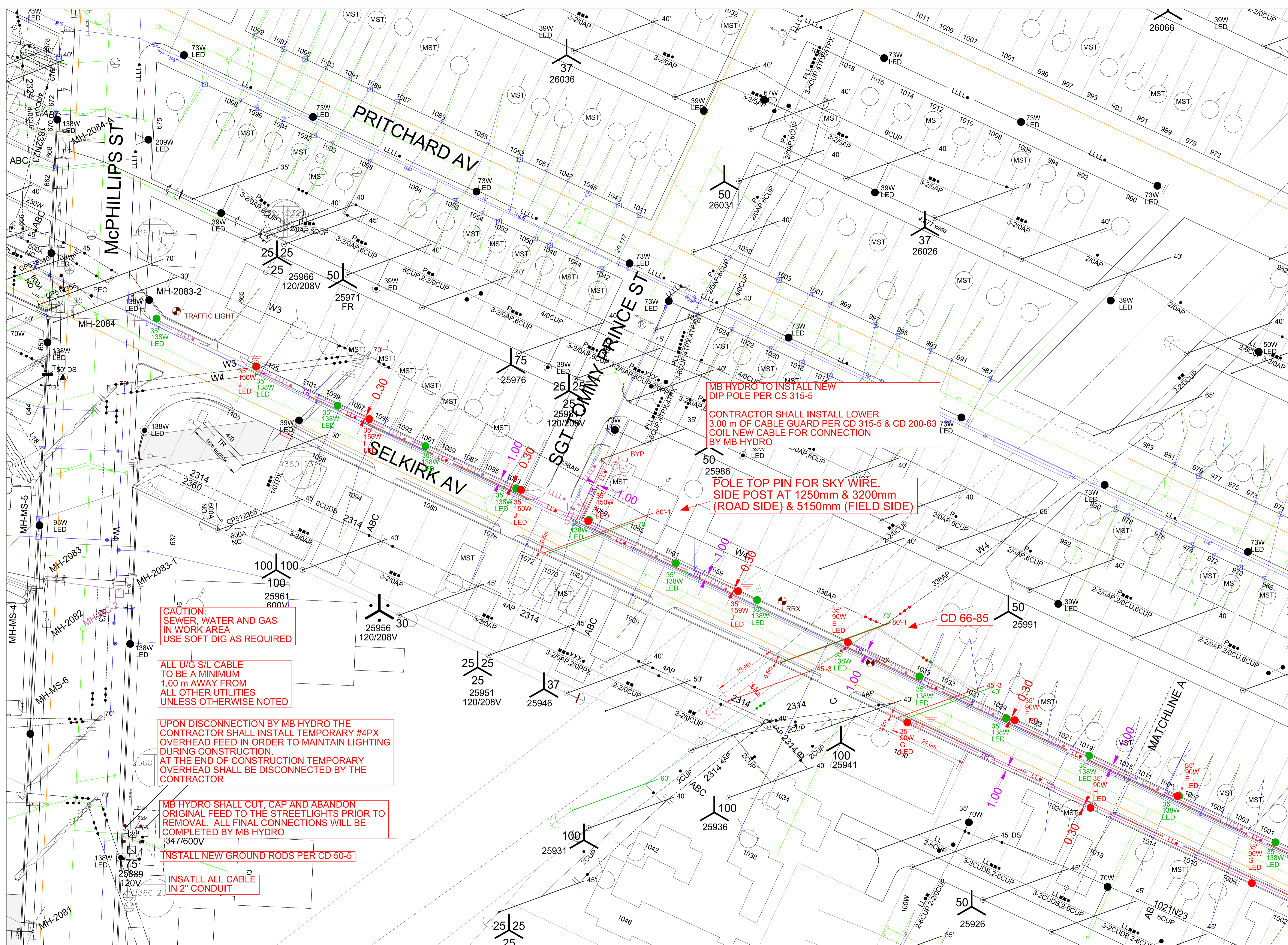

CAUTION: SEWER, WATER AND GAS IN WORK AREA USE SOFT DIG AS REQUIRED

ALL U/G S/L CABLE TO BE A MINIMUM 1.00 m AWAY FROM ALL OTHER UTILITIES UNLESS OTHERWISE NOTED

UPON DISCONNECTION BY MB HYDRO THE CONTRACTOR SHALL INSTALL TEMPORARY #4PX OVERHEAD FEED IN ORDER TO MAINTAIN LIGHTING DURING CONSTRUCTION. AT THE END OF CONSTRUCTION TEMPORARY OVERHEAD SHALL BE DISCONNECTED BY THE CONTRACTOR

MB HYDRO SHALL CUT, CAP AND ABANDON ORIGINAL FEED TO THE STREETLIGHTS PRIOR TO REMOVAL. ALL FINAL CONNECTIONS WILL BE COMPLETED BY MB HYDRO 347/600V

INSTALL NEW GROUND RODS PER CD 50-5

INSATLL ALL CABLE IN 2" CONDUIT

MB HYDRO TO INSTALL NEW DIP POLE PER CS 315-5
CONTRACTOR SHALL INSTALL LOWER 3.00 m OF CABLE GUARD PER CD 315-5 & CD 200-63 COIL NEW CABLE FOR CONNECTION BY MB HYDRO

POLE TOP PIN FOR SKY WIRE. SIDE POST AT 1250mm & 3200mm (ROAD SIDE) & 5150mm (FIELD SIDE)

CD 66-85

CONTACT "CLICK BEFORE YOU DIG MANITOBA" AT ClickBeforeYouDigMB.com
THREE FULL WORKING DAYS
PRIOR TO CONSTRUCTION FOR LOCATION OF EXISTING WATER, WASTEWATER, LAND DRAINAGE UTILITIES AND MANITOBA HYDRO UTILITIES

FOR CLEARANCE OF EXISTING WATER & WASTE DEPARTMENT PLANT CONTACT THE SURVEY & INSPECTION BRANCH 48 HOURS PRIOR TO CONSTRUCTION AT 986-3322

NOTE: INDICATION OF ALL UNDERGROUND UTILITIES IS FOR ILLUSTRATIVE PURPOSES ONLY. CONTACT THE APPLICABLE UTILITIES FOR SPECIFIC PLANT LOCATIONS AND CLEARANCES.

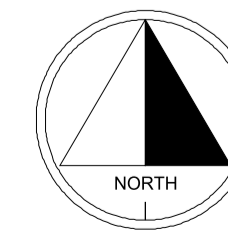

DATE	REVISIONS	BY	CHKD.	APP.
00				

DRAWING NUMBER	REFERENCE DRAWINGS	DRAWN	CHKD.
	UGS APPROVAL	DKGI	

SCALE	CHECK	DATE
1:500		2021 01 12

AREA NUMBER	MANITOBA HYDRO DISTRIBUTION PLANNING & DESIGN
5202	WO# P-33984 NETWORK # 4306473
STATION NUMBER	CSC: CITY CENTRE
FEEDER NUMBER	SYSTEM IMPROVEMENT PROJECT
SYSTEM VOLTAGE	SALVAGE OF STREETLIGHTS AND INSTALLATION OF STREETLIGHT BASES, STANDARDS AND CABLE SELKIRK AV BETWEEN MCPHILLIPS ST AND SINCLAIR ST
	1-04707-DE-50000-0544

NOTES :

CONSTRUCTION STANDARDS

TO BE CONSTRUCTED IN ACCORDANCE WITH MANITOBA HYDRO DISTRIBUTION AND SUBTRANSMISSION STANDARDS, LATEST REVISION. NO MAJOR CHANGE SHALL BE MADE WITHOUT APPROVAL OF THE DESIGN ENGINEER OR DELEGATE.

SURVEYS TO STAKE OUT SURVEY MONUMENTS, IF IN THE VICINITY OF THE NEW CONSTRUCTION TO PREVENT DAMAGE OR LOSS.

INSTALLED			
Quantity	Fixture Type	Wattage	Pole Type
1	LED	60	EXCLUSIVE
25	LED	90	EXCLUSIVE
6	LED	150	EXCLUSIVE
1	LED	240	EXCLUSIVE

SALVAGED			
Quantity	Fixture Type	Wattage	Pole Type
1	LED	73	EXCLUSIVE
34	LED	138	EXCLUSIVE
1	LED	209	EXCLUSIVE

LOCATION	LUMINAIRE	TYPE	MOUNTING HEIGHT	AUG. LUM.	U.L. RATIO	RAIL. RATIO	MAX. ASYMM. INCL. (°)	SPACING

PRELIMINARY
NOT TO BE USED FOR CONSTRUCTION

REEL NUMBER	MANUFACTURER	MANUFACTURE DATE

AUTHORITY	NOTIFIED	NOT REQ'D	OBTAINED
DEPT. OF HIGHWAYS		X	
MUNICIPAL		X	
M.T.S.		X	
GIS		X	
EASEMENTS		X	
CONTROL CENTER		X	
RAILWAY		X	
CATV		X	

CONTACT	NAME	PHONE NUMBER	E-MAIL ADDRESS
DESIGN	IAN MCCALLUM	204-470-3154	imccallum@hydro.mb.ca
DESIGN ENGINEER	MATTHEW SINGER	204-360-2001	msinger@hydro.mb.ca
PROJECT MGMT	DARIN WACH	204-360-3902	dwach@hydro.mb.ca
ESA	TIM LOEB	204-360-5157	Tloeb@hydro.mb.ca
UIG CONSTRUCTION	BRENT KROEGER	204-783-1570	bkrueger@hydro.mb.ca
GH CONSTRUCTION	WAYNE IRELAND	204-360-5796	wireland@hydro.mb.ca
HYDRO GAS			
SHAW			
M.T.S.			
ENG TECH	PHIL BRUCE	431-373-0496	pbruce@hydro.mb.ca
ENG TECH	GEORGE WEDDALL	204-360-7451	gweddall@hydro.mb.ca

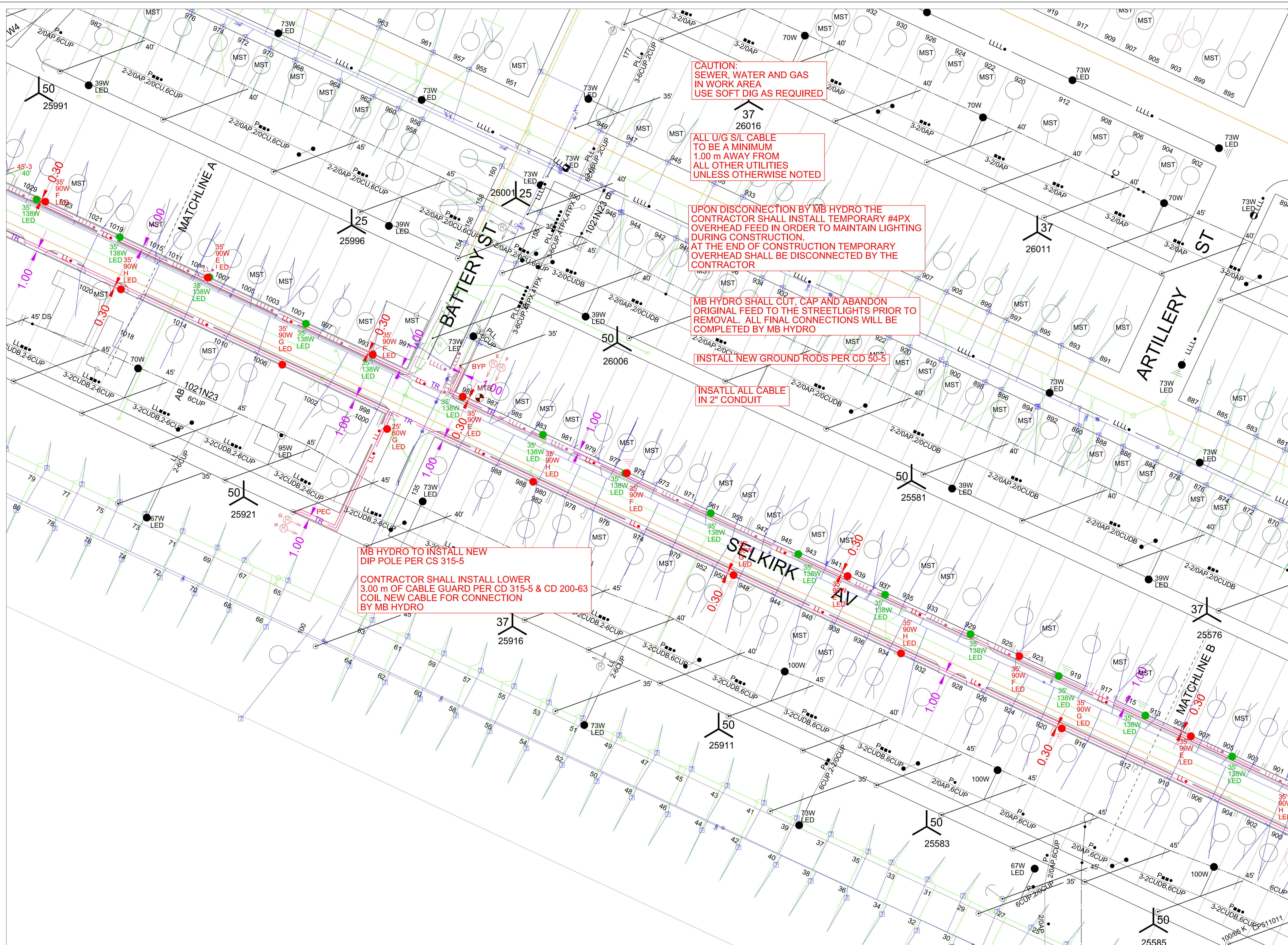

CAUTION: SEWER, WATER AND GAS IN WORK AREA USE SOFT DIG AS REQUIRED

ALL U/G S/L CABLE TO BE A MINIMUM 1.00 m AWAY FROM ALL OTHER UTILITIES UNLESS OTHERWISE NOTED

UPON DISCONNECTION BY MB HYDRO THE CONTRACTOR SHALL INSTALL TEMPORARY #4PX OVERHEAD FEED IN ORDER TO MAINTAIN LIGHTING DURING CONSTRUCTION. AT THE END OF CONSTRUCTION TEMPORARY OVERHEAD SHALL BE DISCONNECTED BY THE CONTRACTOR

MB HYDRO SHALL CUT, CAP AND ABANDON ORIGINAL FEED TO THE STREETLIGHTS PRIOR TO REMOVAL. ALL FINAL CONNECTIONS WILL BE COMPLETED BY MB HYDRO

INSTALL NEW GROUND RODS PER CD 50-5

INSATLL ALL CABLE IN 2" CONDUIT

MB HYDRO TO INSTALL NEW DIP POLE PER CS 315-5 CONTRACTOR SHALL INSTALL LOWER 3.00 m OF CABLE GUARD PER CD 315-5 & CD 200-63 COIL NEW CABLE FOR CONNECTION BY MB HYDRO

CONTACT "CLICK BEFORE YOU DIG MANITOBA" AT ClickBeforeYouDigMB.com
THREE FULL WORKING DAYS
PRIOR TO CONSTRUCTION FOR LOCATION OF EXISTING WATER, WASTEWATER, LAND DRAINAGE UTILITIES AND MANITOBA HYDRO UTILITIES

FOR CLEARANCE OF EXISTING WATER & WASTE DEPARTMENT PLANT CONTACT THE SURVEY & INSPECTION BRANCH 48 HOURS PRIOR TO CONSTRUCTION AT 986-3322

NOTE: INDICATION OF ALL UNDERGROUND UTILITIES IS FOR ILLUSTRATIVE PURPOSES ONLY. CONTACT THE APPLICABLE UTILITIES FOR SPECIFIC PLANT LOCATIONS AND CLEARANCES.

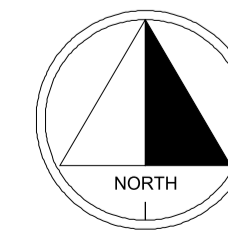

DATE	REVISIONS	BY	CHKD.	APP.
00				

DRAWING NUMBER	REFERENCE DRAWINGS	DRAWN	CHKD.
	UGS APPROVAL	DKGI	

SCALE	CHECK	DATE
1:500		2021 01 12

AREA NUMBER	MANITOBA HYDRO DISTRIBUTION PLANNING & DESIGN
5202	WOF P:33984 NETWORK # 4306473
STATION NUMBER	CSC: CITY CENTRE
1510	SYSTEM IMPROVEMENT PROJECT
FEEDER NUMBER	SALVAGE OF STREETLIGHTS AND INSTALLATION
1021N23 1029N23	OF STREETLIGHT BASES, STANDARDS AND CABLE
SYSTEM VOLTAGE	SELKIRK AV BETWEEN MCPHILLIPS ST AND SINCLAIR ST
4 KV	

NOTES :

CONSTRUCTION STANDARDS

TO BE CONSTRUCTED IN ACCORDANCE WITH MANITOBA HYDRO DISTRIBUTION AND SUBTRANSMISSION STANDARDS, LATEST REVISION. NO MAJOR CHANGE SHALL BE MADE WITHOUT APPROVAL OF THE DESIGN ENGINEER OR DELEGATE.

SURVEYS TO STAKE OUT SURVEY MONUMENTS, IF IN THE VICINITY OF THE NEW CONSTRUCTION TO PREVENT DAMAGE OR LOSS.

INSTALLED			
Quantity	Fixture Type	Wattage	Pole Type
1	LED	60	EXCLUSIVE
25	LED	90	EXCLUSIVE
6	LED	150	EXCLUSIVE
1	LED	240	EXCLUSIVE

SALVAGED			
Quantity	Fixture Type	Wattage	Pole Type
1	LED	73	EXCLUSIVE
34	LED	138	EXCLUSIVE
1	LED	209	EXCLUSIVE

LOCATION	LUMINAIRE	TYPE	INDICATING HEIGHT	AUG. LUC.	U.S. BATHS (U.S. BATHS)	MAX. AV. DIMEN.	MIN. CLEARANCE

PRELIMINARY
NOT TO BE USED FOR CONSTRUCTION

REEL NUMBER	MANUFACTURER	MANUFACTURE DATE

AUTHORITY	NOTIFIED	NOT REQ'D	OBTAINED
DEPT. OF HIGHWAYS		X	
MUNICIPAL		X	
MTS		X	
GIS		X	
EASEMENTS		X	
CONTROL CENTER		X	
RAILWAY		X	
CATV		X	

CONTACT	NAME	PHONE NUMBER	E-MAIL ADDRESS
DESIGN	IAN MCCALLUM	204-470-3154	imccallum@hydro.mb.ca
DESIGN ENGINEER	MATTHEW SINGER	204-360-3201	msinger@hydro.mb.ca
PROJECT MGMT	DARIN WACH	204-360-3202	dwach@hydro.mb.ca
ESA	TIM LOEB	204-360-5157	tloeb@hydro.mb.ca
UIG CONSTRUCTION	BRENT KROEGER	204-793-1570	bkroeger@hydro.mb.ca
OSH CONSTRUCTION	WAYNE IRELAND	204-360-5796	wireland@hydro.mb.ca
HYDRO GAS			
SHAW			
MTS			
ENG TECH	PHIL BRUCE	431-373-0496	pbruce@hydro.mb.ca
ENG TECH	GEORGE WEDDALL	204-360-7451	gweddall@hydro.mb.ca

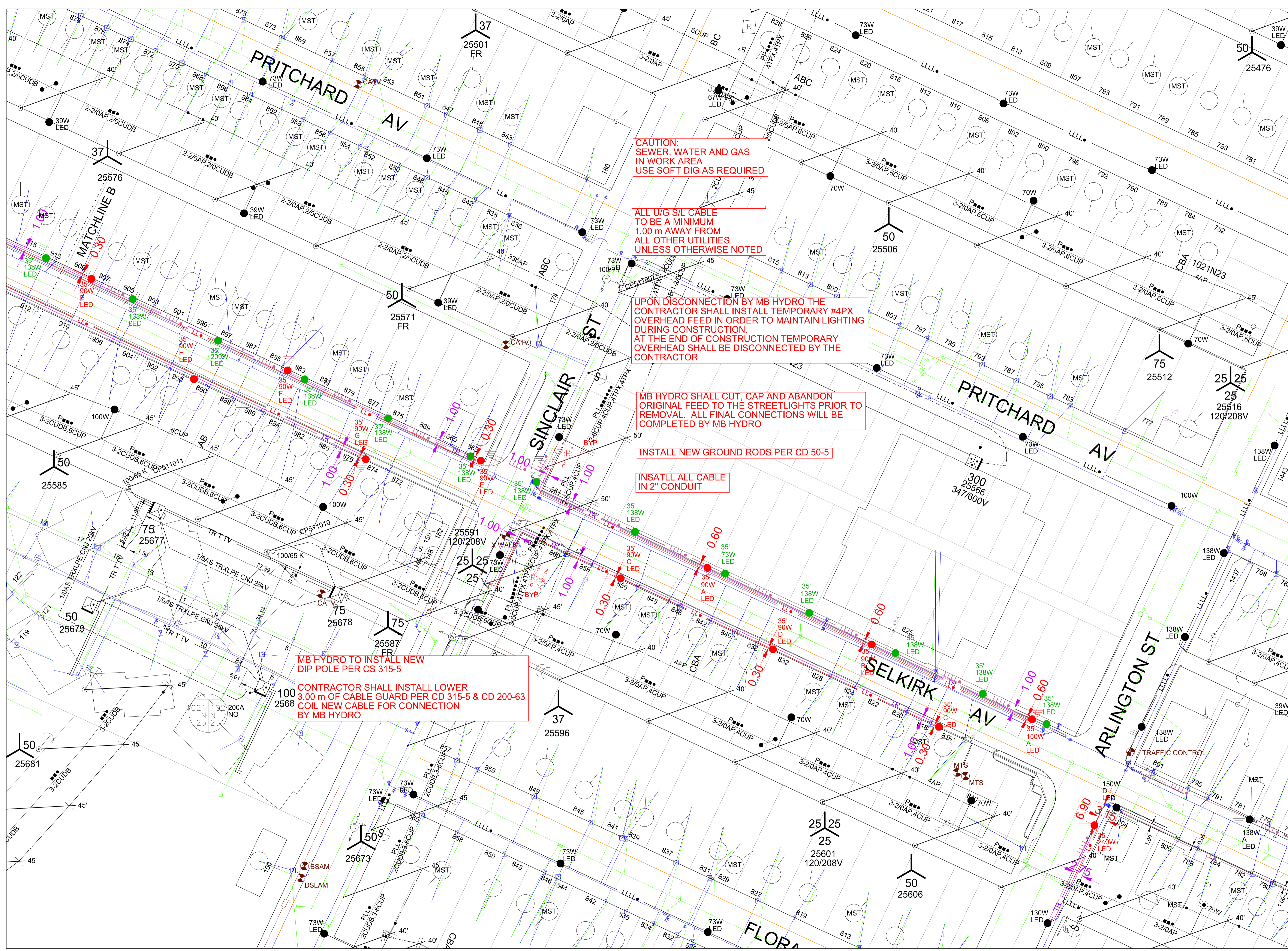

CAUTION: SEWER, WATER AND GAS IN WORK AREA USE SOFT DIG AS REQUIRED

ALL U/G S/L CABLE TO BE A MINIMUM 1.00 m AWAY FROM ALL OTHER UTILITIES UNLESS OTHERWISE NOTED

UPON DISCONNECTION BY MB HYDRO THE CONTRACTOR SHALL INSTALL TEMPORARY #4PX OVERHEAD FEED IN ORDER TO MAINTAIN LIGHTING DURING CONSTRUCTION. AT THE END OF CONSTRUCTION TEMPORARY OVERHEAD SHALL BE DISCONNECTED BY THE CONTRACTOR

MB HYDRO SHALL CUT, CAP AND ABANDON ORIGINAL FEED TO THE STREETLIGHTS PRIOR TO REMOVAL. ALL FINAL CONNECTIONS WILL BE COMPLETED BY MB HYDRO

INSTALL NEW GROUND RODS PER CD 50-5

INSATLL ALL CABLE IN 2" CONDUIT

MB HYDRO TO INSTALL NEW DIP POLE PER CS 315-5

CONTRACTOR SHALL INSTALL LOWER 3.00 m OF CABLE GUARD PER CD 315-5 & CD 200-63 COIL NEW CABLE FOR CONNECTION BY MB HYDRO

FOR CLEARANCE OF EXISTING WATER & WASTE DEPARTMENT PLANT CONTACT THE SURVEY & INSPECTION BRANCH 48 HOURS PRIOR TO CONSTRUCTION AT 986-3322

NOTE: INDICATION OF ALL UNDERGROUND UTILITIES IS FOR ILLUSTRATIVE PURPOSES ONLY. CONTACT THE APPLICABLE UTILITIES FOR SPECIFIC PLANT LOCATIONS AND CLEARANCES.

CONTACT "CLICK BEFORE YOU DIG MANITOBA" AT ClickBeforeYouDigMB.com
THREE FULL WORKING DAYS
PRIOR TO CONSTRUCTION FOR LOCATION OF EXISTING WATER, WASTEWATER, LAND DRAINAGE UTILITIES AND MANITOBA HYDRO UTILITIES

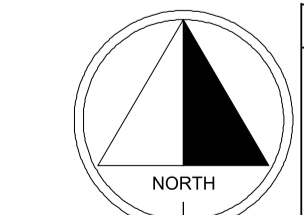

DATE	REVISIONS	BY	CHKD.	APP.
00				

DRAWING NUMBER	REFERENCE DRAWINGS	DRAWN	CHKD.
	UGS APPROVAL	DKGI	

SCALE	CHECK	DATE
1:500		2021 01 12

AREA NUMBER	MANITOBA HYDRO DISTRIBUTION PLANNING & DESIGN
5202	WOF P:33984 NETWORK # 4306473
STATION NUMBER	CSC: CITY CENTRE
FEEDER NUMBER	SYSTEM IMPROVEMENT PROJECT
SYSTEM VOLTAGE	SALVAGE OF STREETLIGHTS AND INSTALLATION OF STREETLIGHT BASES, STANDARDS AND CABLE
1510	SELKIRK AV BETWEEN MCPHILLERS ST AND SINCLAIR ST
1021N23 1029N23	
4 KV	